

Prepared by: Alachua County Department of Growth Management, 10 SW 2nd Avenue, Gainesville, FL 32601, (352) 374-5249, Date: Jul 27, 2005

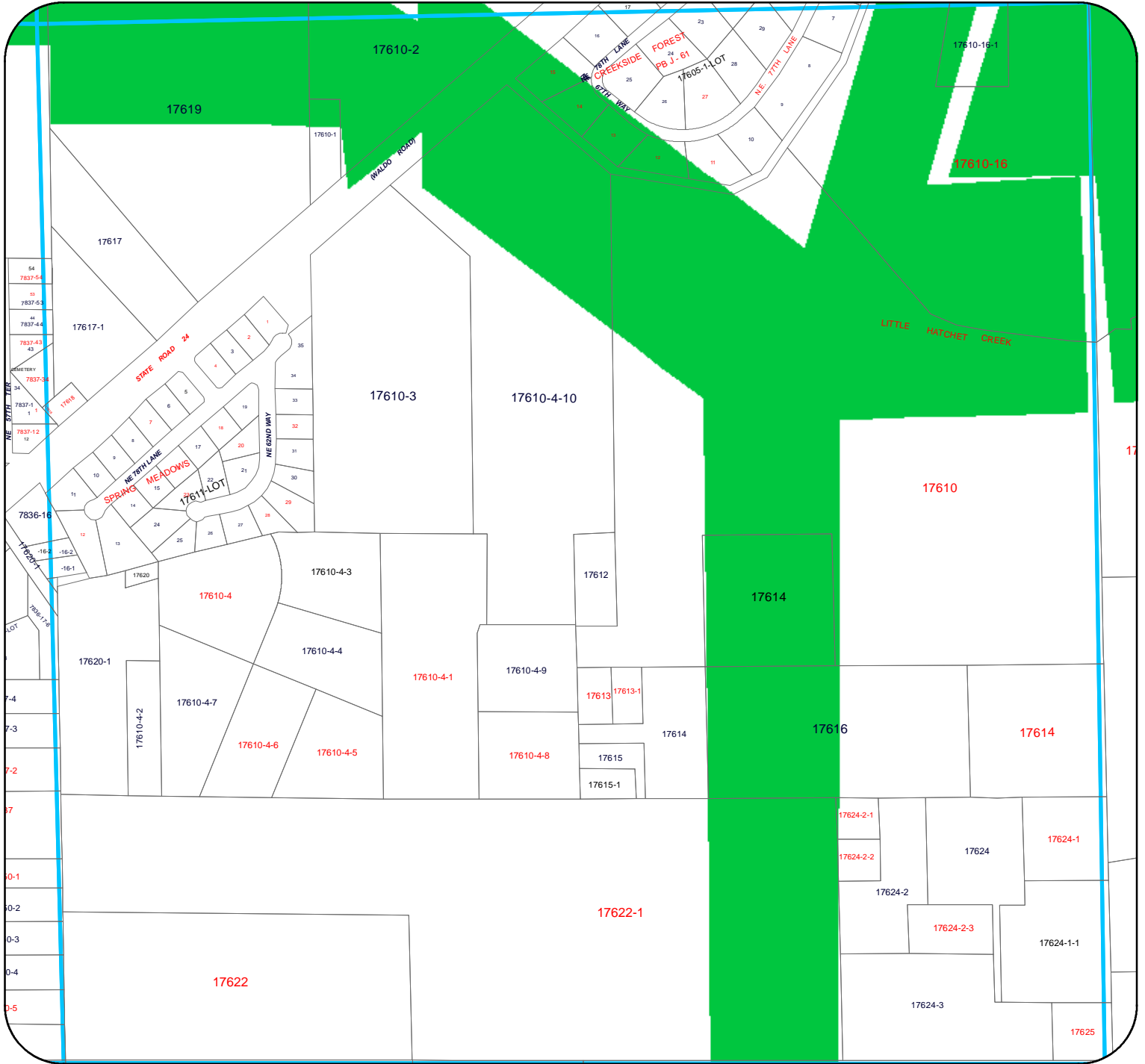

## Legend

- City Limit Line
- Section Line
- Preservation-Future Land Use
- Strategic Ecosystems
- Open Water

### Data Source For Strategic Ecosystems:

KBN/Golder Associates. 1996. "Strategic Ecosystems of Alachua County, Florida."  
 Report prepared for the Alachua County Department of Growth Management by KBN/Golder Associates.